

Order Codes DGOZ-DINBSR-01

Overview This DIN mounted relay is suitable for the control of ac and dc motors commonly used for curtains, blinds, shutters and tilting shading systems. This relay product can be used in any DALI system. Operations include manual control – UP/OPEN, DOWN/CLOSE and STOP. Commissioning options allow proportional control, for example setting the amount open or tilt angle. Hardware interlocks ensure that only one of the outputs UP/OPEN or DOWN/CLOSE can be active at any time. Cable termination uses high quality rising cage clamp style screw terminals, and is suitable for terminating 1.5 mm² or 2.5 mm² cables (ac supply cables, switched load cables and DALI Line cables). This product needs no external power supply – it is powered from the DALI line.

Features Suitable for blind / shutter / curtain / tilt motors. Can be used with both ac and dc motors – see ratings. LED indicators (DALI and output on). Button control UP/OPEN, DOWN/CLOSE and STOP. Proportional control for amount open or tilt angle in increments of 1%. DALI commands for stepping UP/OPEN or DOWN/CLOSE in 10% steps. DALI Scenes can be used for amount open presets. DALI Short Address, Group Addresses and DALI Scenes are configured using RAPIX Addressing or RAPIX Integrator software. Can also be commissioned using other DALI commissioning software that supports DALI Device Type 7. Complies with DALI-2 standard IEC 62386 and Device Type 7 (Switching Function).

Typical Applications Commercial buildings, Meeting and board rooms, Education facilities, Health care facilities, Hotels, Homes.

Typical Wiring / Connection Diagrams

Typical Connection – Mains ac Motor

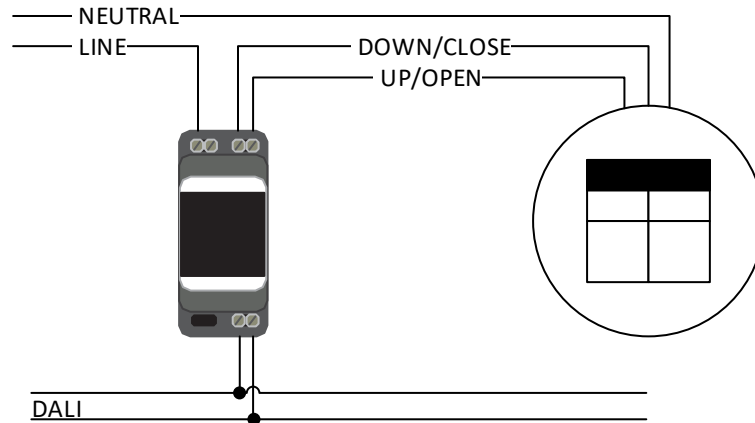

Typical Connection – 12-24 V dc Motor

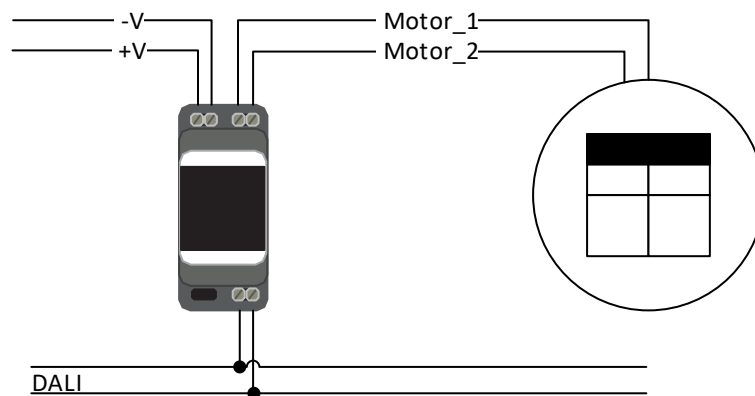
Important Safety Notes

- For all blind / shutter / gate / door / shading system types: Limit switches must be present. These are not shown in the connection diagrams. Reputable motors included these switches.
- For dc motors, the DGOZ-DINBSR-01 reverses the polarity. When at either limit, the motor must be capable of reversing direction if the power is applied with reverse polarity.
- For dc motors, M1 is positive for DOWN/CLOSE, and M2 is positive for UP/OPEN.

Incompatible Motor Types

This product is not suitable for:

- motors that use a wireless remote control with receiver built into the tubular motor; or
- dc motors that include batteries.

Specifications

Parameter	Specification
DALI Compliance	DALI and DALI-2
DALI Operating Voltage	16 V dc (nominal), with suitable operation from 9.5 V – 22.5 V
DALI Line Current Draw	4 mA (peak) 2 mA (average)
DALI Mains Tolerance	DALI input is mains voltage tolerant
DALI Device Type	Type 7
Power source	DALI Line
Electrical Isolation	4 kV (Input/Output terminals to DALI)
Status Indicators	DALI Present & Identification - Green Output energised (Motor running) - Green
Rating – ac motors	100 V – 240 V ac, 50/60 Hz: 2 A (1 hp)
Rating – dc motors	12 – 24 V dc: 2 A
Relay Switch Operations	> 10 000 operations at maximum of rated load
Start-up time	15 seconds from DALI power application
Standby Power Consumption	25 mW
DALI Failure Behaviour	Motor is de-energised when DALI power is removed
Motor and Power Terminals	2 x 2.5 mm ² maximum per terminal or 3 x 1.5 mm ² maximum per terminal
DALI Terminals	2 x 2.5 mm ² maximum per terminal or 3 x 1.5 mm ² maximum per terminal
Operating Temp. Range	0 - 50°C
Operating Humidity Range	0% to 95% RH non-condensing
Ingress protection	IP20
Materials	Enclosure/fascia – flame resistant polycarbonate DIN rail clip – ABS
Weight	150 g

Standards & Compliance

IEC/EN 60669-2-1, AS/NZS 60669.2.1
 IEC/EN 61000-3-2, -3, AS/NZS 61000.3.2, .3
 IEC/EN 61000-4-2, -3, -4, -5, -6, -8, -11
 EN 61547
 IEC/EN 55015, AS/NZS CISPR 15, AS CISPR 15

DALI Standards and Compliance

IEC 62386-101 Ed2 (DALI-2)
 IEC 62386-102 Ed2 (DALI-2)
 IEC 62386-208 (Switching Function)

EC Council Directives

2014/35/EU Low Voltage
 2014/30/EU Electromagnetic Compatibility (EMC)
 2015/863 Restriction of Hazardous Substances (RoHS) in Electrical and Electronic Equipment

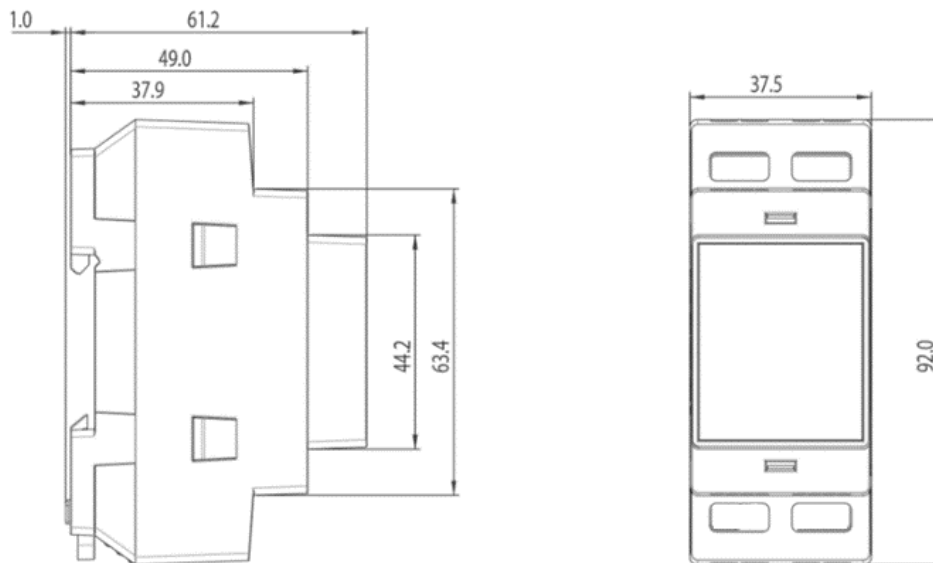

Dimensions**Contact Information**

Web www.ozuno.com
All Enquiries +61 8 8362 7584 sales@ozuno.com

Ozuno Trading Pty Ltd

ABN: 96 621 194 483

This product includes a **TWO-YEAR WARRANTY** against manufacturing defects.

RAPIX is a trademark of Ozuno Holdings Pty Ltd.

COPYRIGHT © 2023 This document is copyright by Ozuno Holdings Pty Ltd. Except as permitted under relevant law, no part of this data sheet may be reproduced by any process without written permission of and acknowledgement to Ozuno.

DISCLAIMER. Ozuno Holdings Pty Ltd (Ozuno) reserves the right to alter the specifications, designs or other features of any items and to discontinue any items at any time without notice and without liability. While every effort is made to ensure that all information in this Data Sheet is correct, no warranty of accuracy is given and Ozuno shall not be liable for any error.

TRADEMARKS. The identified trademarks and copyrights are the property of Ozuno Holdings Pty Ltd unless otherwise noted.

13-20-505-101-01 March 2023