



Order Code	DKOZ-RLY-16A-01	One Channel
	DKOZ-RLY-16A-02	Two Channels

**Overview**

DALI-2 one and two channel relays designed for on/off switching of up to 16 Amps per channel of lighting load via DALI commands issued on a connected DALI line.

The on-board 240 V ac rated relay on each channel is capable of switching a full 16 A of LED, fluorescent, incandescent and HID lighting loads, making it suitable for a wide range of commercial and industrial building applications.

The relay unit includes a large area for terminating all 1.5 mm<sup>2</sup> or 2.5 mm<sup>2</sup> double insulated cables (ac supply cables, switched load cables and DALI Line cables).

High robustness switching components are used with very high inrush rating, making these relays suitable for modern LED and other load types.

- Features**
- General purpose load switching (ON and OFF) via received DALI commands.
  - Capable of switching 16 AX @ 240 V ac.
  - Very high inrush current rating: 500 A (2 ms) on each channel.
  - Includes large Neutral and Earth termination bars.
  - Suitable for mounting in a ceiling void.
  - Optional DIN rail mounting bracket.
  - Fits through a 90 mm downlight hole.
  - LED indicators (DALI and power).
  - Each channel uses a single DALI Short Address; can be including in up to 16 DALI Group Addresses and/or up to 16 DALI Scenes.
  - DALI Short Address, Group Addresses and DALI Scenes are configured using RAPIX Addressing or RAPIX Integrator software. Can also be commissioned using other DALI commissioning software that supports DALI Device Type 7.
  - Complies with DALI standard IEC 62386 Ed 2 and Device Type 7 (Switching Function).
  - Implements the full set of optional Device Type 7 relay threshold functions.

**Typical Applications** Commercial & Industrial buildings, Education Facilities, Health care facilities, Hotels, Warehouses, Homes.

### Connections

One Channel Relay: DGOZ-RLY-16A-01

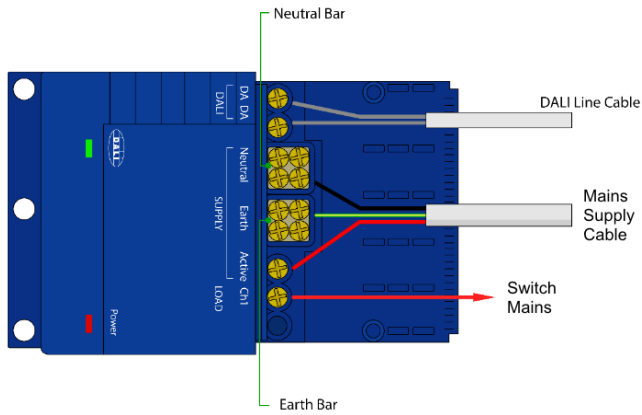

Two Channel Relay: DGOZ-RLY-16A-02

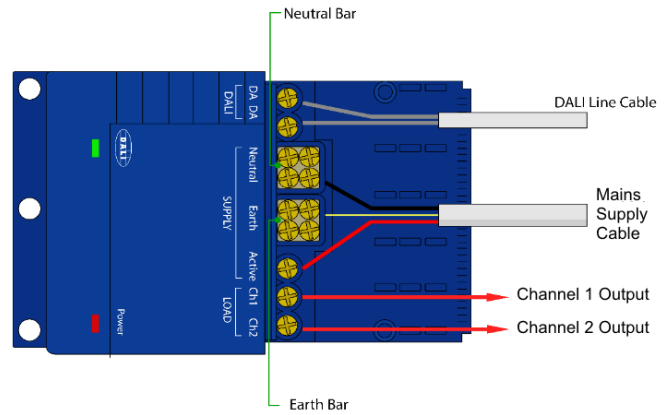

### Specifications

Parameter	Specification
Number of Switched Outputs	DGOZ-RLY-16A-01: 1 DGOZ-RLY-16A-02: 2
DALI Compatibility	DALI and DALI-2
DALI Operating Voltage	16 V dc (nominal), with suitable operation from 9.5 V – 22.5 V
DALI Line Current Draw	2 mA
DALI Mains tolerance	DALI input is mains voltage tolerant
DALI Device Type	Type 7 – optional threshold switching functions fully implemented
Power source	ac mains
Nominal Mains Supply Voltage	100 – 240 V ac
Mains Frequency Range(s)	47 – 63 Hz
Electrical Isolation	4 kV (DALI to Mains)
Status Indicators	Power – Red ON                      DALI – Green ON
Load Rating	Ac Loads: Resistive, Inductive, Fluorescent, LED, Capacitive: 16 A per channel Motor: 2 A (1 HP) per channel
Inrush Current Rating	500 A (2 ms)
Relay Switch Operations	> 50 000 operations at rated load
Relay Contact Type	Bifurcated High Inrush
Standby Power	< 150 mW
Mains Terminals	2 x 2.5 mm <sup>2</sup> maximum per terminal or 3 x 1.5 mm <sup>2</sup> maximum per terminal
DALI Terminals	2 x 2.5 mm <sup>2</sup> maximum per terminal or 3 x 1.5 mm <sup>2</sup> maximum per terminal
Operating Temp. Range	0 - 50°C
Operating Humidity Range	0% to 95% RH non-condensing
Ingress protection	IP20
Mounting Arrangement	Surface mount via 6 mm mounting holes DIN rail mounting (with optional DIN rail mounting bracket)
Housing Material Type	Flame Retardant Polycarbonate, UL 94V-0
Weight	1 Channel: 160 g 2 Channel 175 g

**Standards & Compliance*****EMC and Electrical Safety Frameworks and Standards***

IEC 60669-2-1, EN 60669-2-1, AS/NZS 60669.2.1  
IEC 61000-3-2, -3, EN 61000-3-2, -3, AS/NZS 61000-3-2, -3  
IEC 61000-4-2, -3, -4, -5, -6, -8, -11  
EN61547:2009  
AS/NZS CISPR 15:2011

***DALI Standards and Compliance***

IEC 62386-101 Ed 2 (DALI-2)  
IEC 62386-102 Ed 2 (DALI-2)  
IEC 62386-208 (Device Type 7, switching function)

***EC Council Directives***

2014/35/EU Low Voltage  
2014/30/EU Electromagnetic Compatibility (EMC)  
2015/863 Restriction of Hazardous Substances (RoHS) in Electrical and Electronic Equipment

**IP20**

**Dimensions**

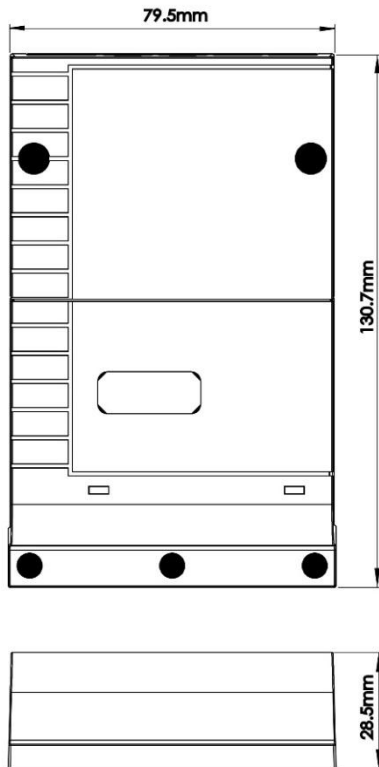

DALI Relay Device

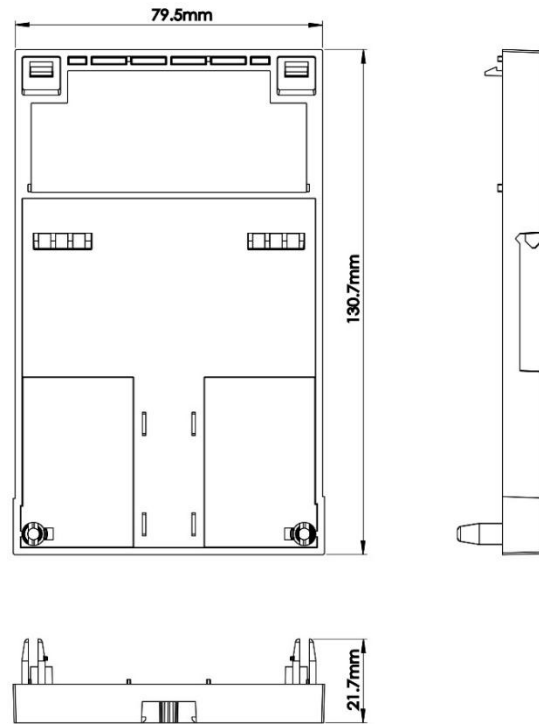

Optional Mounting Bracket

**Contact Information**

Web [www.ozuno.com](http://www.ozuno.com)  
All Enquiries +61 8 8362 7584 [sales@ozuno.com](mailto:sales@ozuno.com)

**Ozuno Trading Pty Ltd**

ABN: 96 621 194 483

This product includes a **TWO-YEAR WARRANTY** against manufacturing defects.

**RAPIX** is a trademark of Ozuno Holdings Pty Ltd.

**DALI** and **DALI-2** are trademarks of the Digital Illumination Interface Alliance.

**COPYRIGHT** © 2019-2026 This document is copyright by Ozuno Holdings Pty Ltd. Except as permitted under relevant law, no part of this data sheet may be reproduced by any process without written permission of and acknowledgement to Ozuno.

**DISCLAIMER.** Ozuno Holdings Pty Ltd (Ozuno) reserves the right to alter the specifications, designs or other features of any items and to discontinue any items at any time without notice and without liability. While every effort is made to ensure that all information in this Data Sheet is correct, no warranty of accuracy is given and Ozuno shall not be liable for any error.

**TRADEMARKS.** The identified trademarks and copyrights are the property of Ozuno Holdings Pty Ltd unless otherwise noted.

13-14-018-001-04 April 2026